

# Brian's Infamous and Fiendish BSCC Christmas and Technology Quiz

3 December 2021



# Brian's BSCC Christmas and Technology Quiz



- Questions are either Christmas or Technology related
- Christmas related questions are marked with 
- To make it easier, at least three possible answers are given for each question – all you have to do is pick the right one
- Possible answers are generally listed in alphabetical order
- There are 15 questions this year
- Warning: hard questions are at the beginning and then gradually get more difficult!

**Q1** 🌿

According to the song, what was Frosty the Snowman's nose made out of?

A: Button

B: Carrot

C: Coal

## Q2

Often considered the father of modern computer science, Alan Turing was famous for his work developing the first modern computers, decoding the encryption of German Enigma machines during the second world war and detailing a procedure known as the Turing Test, forming the basis for artificial intelligence.

Alan Turing's face features on which English banknote?

A: £5

B: £10

C: £20

D: £50

---

### Q3

According to researchers, which of the following keys is pressed most frequently on a standard UK keyboard?

A: Enter

B: Shift

C: Spacebar

---

## Q4

These should be familiar images, but which one is NOT the correct design?



A: Microsoft Edge



B: Facebook



C: Zoom

Q5 

Rudolph red nose is probably caused by parasites, but is Rudolph male or female?

A: Male

B: Female

C: No one knows

---

## Q6

Which keyboard symbol do the Chinese call 'little mouse' and the Danes and Swedes call 'elephant trunk'?

A: &

B: >

C: @

---



## Q7

'Hi-Fi' stands for High Fidelity but what does 'Wi-Fi' stand for?

A: Wireless Fibre

B: Wireless Fidelity

C: It isn't short for anything

---

## Q8

Which of the following words cannot be typed using only the keys on the top row of a standard UK keyboard?

A: Prerequisite

B: Repertoire

C: Typewriter

---

## Q9

Most people are familiar with the song "The Twelve Days of Christmas." It's about gifts that are sent to a lover during the twelve days from Christmas Day, December 25<sup>th</sup>, until January 5<sup>th</sup>.

Based on prices at the end of 2020, the cheapest item is the Partridge in a Pear tree at around \$210. Which of the other eleven is the most expensive?

A: Five Golden Rings

B: Six Geese-a-Laying

C: Seven Swans-a-Swimming

---

## Q10

First introduced in Microsoft Office 97, the Office Assistant appeared when a program determined the user could be assisted by using Office wizards, searching help, or advising users on using Office features more effectively. It also presented tips and keyboard shortcuts. For example, typing an address followed by "Dear" would cause the Assistant to appear with the message, "It looks like you're writing a letter. Would you like help?". The default assistant in the English version was a paperclip although other assistants available included a cat, dog, robot and caricature of Albert Einstein. They were retired after the release of Office 2007. What was the proper name of the paperclip?

A: Clippit

B: Clippy

C: Scribble

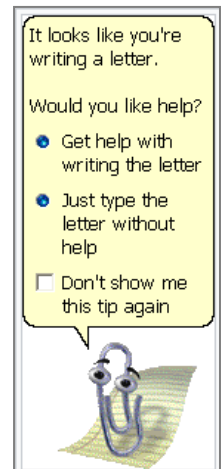

## Q11

The UK now has the world's 43<sup>rd</sup> fastest broadband, up from 47<sup>th</sup> in 2020 but down from 34<sup>th</sup> place in 2019. Average speed is 51.48Mbps up from 37.82Mbps last year.

The top five 'countries' are listed below alphabetically but which 'country' came top of the table with an average speed of 274Mbps?

A: Andorra      B: Gibraltar      C: Iceland      D: Jersey      E: Liechtenstein

---

## Q12

Which of the following characters can you NOT use in a Windows filename?

A: . (a dot)

B: / (forward slash)

C: a space

### Q13

The first emoji were created in 1999 by Japanese artist Shigetaka Kurita, In 2010, in order to standardise them across different systems, emoji were recognized by the Unicode Consortium, a non-profit group that works like the United Nations to maintain text standards across computers. By September 2020 there were over 3,521 in the Unicode Standard.

According to the Unicode Consortium report in 2019, which was the most frequently used emoji?

A: Smiley Face 

B: Face with Tears of Joy 

C: Thumbs Up 

---

## Q14

A hacker is someone who uses computers to gain unauthorized access to data.

Consequently, having the address of 1 Hacker Way in Silicon Valley doesn't sound very desirable but which of these major technology companies has it as the address for its global headquarters?

A: Apple

B: Facebook

C: Microsoft

---



## Q15

Which is most downloaded App of 2021?

A: Facebook

B: Instagram

C: Tik-Tok

---



## Answers

**Q1** 

According to the song, what was Frosty the Snowman's nose made out of?

A: Button

B: Carrot

C: Coal

---

**Answer A:** Button

*That's Frosty the Snowman, He's a jolly happy soul, With a corncob pipe and a button nose,  
And two eyes made out of coal.*

## Q2

Often considered the father of modern computer science, Alan Turing was famous for his work developing the first modern computers, decoding the encryption of German Enigma machines during the second world war and detailing a procedure known as the Turing Test, forming the basis for artificial intelligence.

Alan Turing's face features on which English banknote?

A: £5

B: £10

C: £20

D: £50

**Answer D: £50**

*£5 features Sir Winston Churchill*

*£10 features Jane Austen*

*£20 features JMW Turner.*



### Q3

According to researchers, which of the following keys is pressed most frequently on a standard UK keyboard?

A: Enter

B: Shift

C: Spacebar

---

**Answer C: Spacebar**

*The third most popular is... the "backspace" key.*

*The second most popular is... the letter "e".*

*The number one most popular is... the space bar.*

## Q4

These should be familiar images, but which one is NOT the correct design?



A: Microsoft Edge



B: Facebook



C: Zoom

---

**Answer C: Zoom**

*The correct design looks like this:*



Q5 

Rudolph red nose is probably caused by parasites, but is Rudolph male or female?

A: Male

B: Female

C: No one knows

---

**Answer B: Female**

*Rudolph, and all of the other reindeer associated with Santa at Christmas, still have their antlers and are therefore, by definition, female. Male reindeer shed their antlers in winter.*

## Q6

Which keyboard symbol do the Chinese call 'little mouse' and the Danes and Swedes call 'elephant trunk'?

A: &

B: >

C: @

---

**Answer C: @**

*The at sign, @, is normally read aloud as "at"; it is also commonly called the at symbol, commercial at or address sign. It is used as an accounting and invoice abbreviation meaning "at a rate of" (e.g. 7 widgets @ £2 per widget = £14), but it is now seen more widely in email addresses and social media platform handles.*

*The absence of a single English word for the symbol has prompted some writers to use the French arobase or Spanish and Portuguese arroba, or to coin new words such as ampersat, asperand, and strudel, but none of these have achieved wide use.*



## Q7

'Hi-Fi' stands for High Fidelity but what does 'Wi-Fi' stand for?

A: Wireless Fibre

B: Wireless Fidelity

C: It isn't short for anything

---

### Answer C: It isn't short for anything

*Wi-Fi, often referred to as WiFi, wifi, wi-fi or wi fi, is often thought to be short for Wireless Fidelity but there is no such thing.*

*The term was created by a marketing firm because the wireless industry was looking for a user-friendly name to refer to some not so user-friendly technology known as IEEE 802.11.*

## Q8

Which of the following words cannot be typed using only the keys on the top row of a standard UK keyboard?

A: Prerequisite

B: Repertoire

C: Typewriter

---

**Answer A:** Prerequisite

*Prerequisite includes the letter 's' which is on the second row of a standard UK keyboard.*

*Appropriately enough, the 10-letter word typewriter is one of the longest words that can be spelled using just the top row of letters on a qwerty keyboard; some of the others include peppertree, perpetuity, proprietor and repertoire .*

## Q9

Most people are familiar with the song "The Twelve Days of Christmas." It's about gifts that are sent to a lover during the twelve days from Christmas Day, December 25<sup>th</sup>, until January 5<sup>th</sup>.

Based on prices at the end of 2020, the cheapest item is the Partridge in a Pear tree at around \$210. Which of the other eleven is the most expensive?

A: Five Golden Rings

B: Six Geese-a-Laying

C: Seven Swans-a-Swimming

---

### Answer C: Seven Swans-a-Swimming

*The seven swans swimming are not a bargain at all. In fact, they are the most expensive items in the song. Even though the price has been about the same as the last four years, the swans aren't cheap. The price is still about \$13,125.*

*Although the price of gold generally increases from year to year, the price of five gold rings in 2020 was about \$945.*

*To gift someone with a goose is special, but to give six is very special. Not only are the geese valuable, but they also lay eggs which increases their value. The price of the six geese-a-laying in 2020 was \$570, a 35% price increase over the 2019 price.*

## Q10

First introduced in Microsoft Office 97, the Office Assistant appeared when a program determined the user could be assisted by using Office wizards, searching help, or advising users on using Office features more effectively. It also presented tips and keyboard shortcuts. For example, typing an address followed by "Dear" would cause the Assistant to appear with the message, "It looks like you're writing a letter. Would you like help?". The default assistant in the English version was a paperclip although other assistants available included a cat, dog, robot and caricature of Albert Einstein. They were retired after the release of Office 2007. What was the proper name of the paperclip?

A: Clippit

B: Clippy

C: Scribble

### Answer A: Clippit

*The default assistant in the English version was named Clippit (commonly nicknamed Clippy), after a paperclip. Clippit was by far the most notable Assistant (partly because in many cases the setup CD was required to install the other assistants), which also led to it being called simply the Microsoft Paperclip. The original Clippit in Office 97 was given a new look in Office 2000.*

*In July 2021, Microsoft announced Clippy would replace the paperclip emoji in Microsoft 365.*

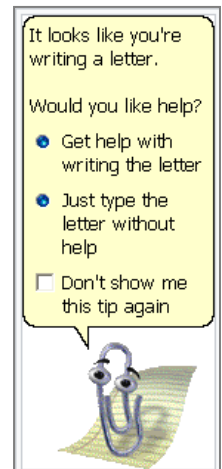

## Q11

The UK now has the world's 43<sup>rd</sup> fastest broadband, up from 47<sup>th</sup> in 2020 but down from 34<sup>th</sup> place in 2019. Average speed is 51.48Mbps up from 37.82Mbps last year.

The top five 'countries' are listed below alphabetically but which 'country' came top of the table with an average speed of 274Mbps?

A: Andorra      B: Gibraltar      C: Iceland      D: Jersey      E: Liechtenstein

---

**Answer D: Jersey (274Mbps)**

*The second to fifth fastest are:*

2. *Liechtenstein: 211 Mbps*
3. *Iceland: 192Mbps*
4. *Andorra: 165Mbps*
5. *Gibraltar: 151Mbps*

## Q12

Which of the following characters can you NOT use in a Windows filename?

A: . (a dot)

B: / (forward slash)

C: a space

---

**Answer B:** / (forward slash)

*A Windows filename cannot contain any of the following characters:*

\ / : \* ? " < > |

## Q13

The first emoji were created in 1999 by Japanese artist Shigetaka Kurita, In 2010, in order to standardise them across different systems, emoji were recognized by the Unicode Consortium, a non-profit group that works like the United Nations to maintain text standards across computers. By September 2020 there were over 3,521 in the Unicode Standard.

According to the Unicode Consortium report in 2019, which was the most frequently used emoji?



A: Smiley Face 

B: Face with Tears of Joy 

C: Thumbs Up 

---

### Answer B: Face with Tears of Joy

*The Unicode Consortium reported in 2019 that “face with tears of joy” (  ) is the most frequently used emoji, eclipsing the “red heart” (  ) and “smiling face with heart-eyes” (  ) which came in second and third respectively.*

## Q14

A hacker is someone who uses computers to gain unauthorized access to data.

Consequently, having the address of 1 Hacker Way in Silicon Valley doesn't sound very desirable but which of these major technology companies has it as the address for its global headquarters?

A: Apple

B: Facebook

C: Microsoft

---

### Answer B: Facebook

*Facebook is now owned by new parent company Meta but has a number of offices in Hacker Way .*

*Apple's address is 1 Infinite Loop and Microsoft's is 1 Microsoft Way.*



## Q15

Which is most downloaded App of 2021?

A: Facebook

B: Instagram

C: Tik-Tok

---

### Answer C: Tik-Tok

*TikTok is a Chinese social media app that enables users to make and share 15-second videos which are often set to music and usually feature choreography.*

*Facebook , which came second, is a social networking website where users can post comments, share photographs, and post links to news or other interesting.*

*Instagram, which came third, allows users to edit and upload photos and short videos through a mobile app. Instagram was acquired by Facebook in 2012.*

*WhatsApp. Also owned by Facebook, came fourth.*



Merry Christmas and a  
Happy New Year